

Thermodynamic Steam Trap

TD 62 (Screwed / Socket Weld)

Description :

The TD 62 is a maintainable high pressure thermodynamic steam trap with integral strainer specifically designed for mains drainage applications. An insulating cover is fitted as standard to prevent the trap being unduly influenced by excessive heat loss when subjected to low outside temperatures, wind, rain etc.

Limiting Conditions :

Body design conditions ANSI 600
 PMA - Max. Allowable Press. 103 bar g.
 TMA - Max. Allowable Temperature 525°C.
 Cold Hydraulic Test Pressure 155 bar g.

Operating Range :

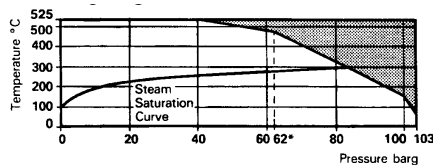

The product must not be used in this region.

* PMO - Max. operating pressure recommended
 PMCB - Max. operating back pressure 80% of upstream Pressure.

Note : Minimum pressure for satisfactory operation is 1.4 barg.

Sizes and Pipe Connections :

$\frac{1}{2}$ "ⁿ, $\frac{3}{4}$ "ⁿ, 1" screwed ends NPT
 $\frac{1}{2}$ "ⁿ, $\frac{3}{4}$ "ⁿ, 1" screwed weld ends to ANSI B16.11 Class 3000.

Materials :

No.	Part	Material
† 1	Body	Steel ASTM A217 Gr WC 6
2	Cover	Steel ASTM A217 Gr WC 6
3	Strainer Cap	Steel ASTM A217 Gr WC 6
4	Strainer Screen	Stainless Steel BS 1449 316 S13
5	Insulating Cover	Aluminium BS 1470 1200 S1CH4
6	Disc	Chromium Steel BS 4659 Gr BD2
7	Cover studs	Steel ASTM A193 Gr B16
8	Cover Nuts	Steel ASTM A194 Gr 8M
9	Cover Gasket	Spirally Wound Stainless Steel with Exfoliated Graphite Filler
10	Cap Gasket	Reinforced Exfoliated Graphite
† 11	Seat	Chromium Steel BS 4569 Gr BD2
12	Nameplate	Stainless Steel

† **Note :** Item 11 is vacuum brazed into Item 1.

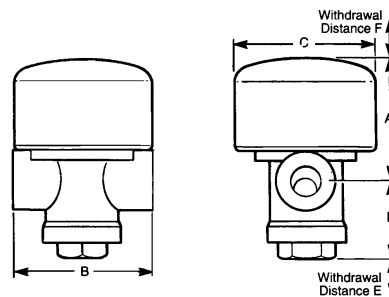
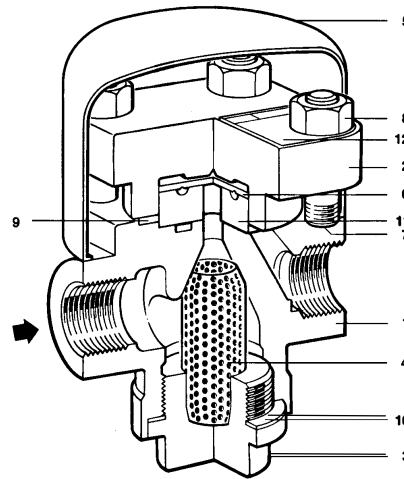

Dimensions : (approx.) in mm

Size	A	B	C	D	E	F	Weight
1/2"	79	92	92	51	20	51	2.08 kg
3/4"	79	92	92	51	20	51	2.08 kg
1"	84	100	92	46	20	51	2.43 kg

How to specify :

1/2" Spirax Sarco TD 62 Thermodynamic Disc Steam Trap with integral strainer screwed NPT

Capacities :

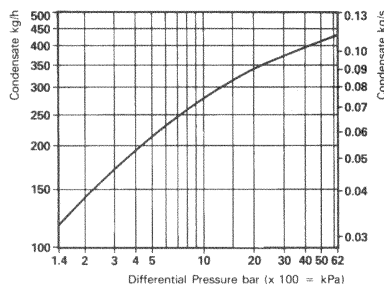

Installation :

Preferably in horizontal pipelines with Insulating Cover uppermost although can be fitted in other positions. After 24 hours in service the cover nuts should be checked for tightness. Separate installation and Maintenance instructions give full details.

Spare Parts :

The spare parts available are shown in heavy outline. Parts drawn in broken line are not supplied as spares.

AVAILABLE SPARES

Insulating Cover	5
Set of Cover Studs and Nuts (set of 4)	7,8
Disc (Pkt of 3)	6
Strainer Screen	4
Set of Gaskets (Pkt 3 of each)	9,10

How to Order :

Always order spares by using the description given in the column headed available spare.

Example : 1 -- Strainer Screen for SPIRAX SARCO TD 62 Steam Trap.

Before undertaking any maintenance on the trap it must be isolated from both the supply and return lines and any pressure allowable to safely normalise to atmosphere. The trap assembly should then be allowed to cool.

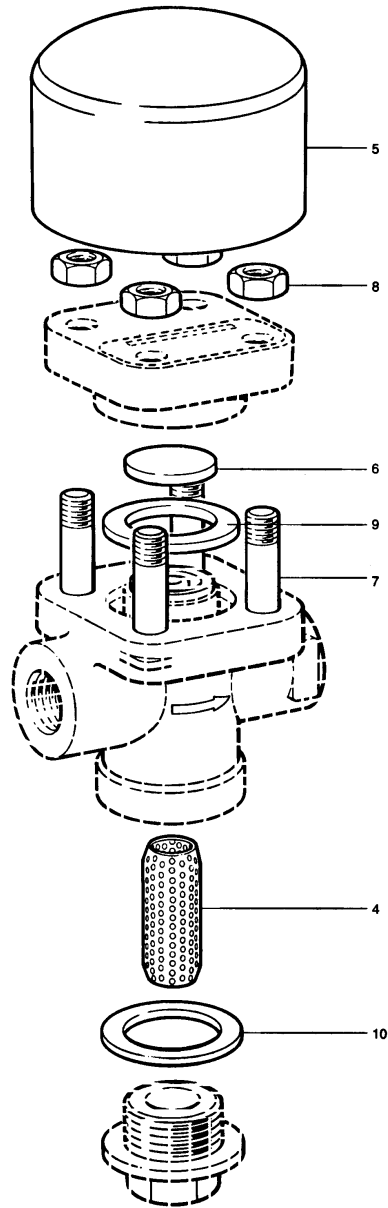

How to Fit Disc :

Spring off Insulating Cover, unscrew the four nuts and remove top cover. Lift off the disc. Fit new disc making sure that the body seating surface is not unduly worn. If the body seating surface is slightly worn it can be refaced by lapping individually on a flat surface such as a surface plate. A figure of eight motion and a little grinding compound such as the Carborundum Co's compound I.F. gives the best results.

If the wear is too great to be rectified by simple lapping the seating faces on the body must be ground flat and then lapped. The total amount of metal removed in this way should not exceed 0.25 mm. Reassemble cover using a new gasket making sure that gasket faces are perfectly clean. Ensure nameplate is placed over studs prior to reassembling nuts. Spring on insulating Cover. After 24 hours in service and when reassembling, the nuts should be tightened in a diagonally opposite sequence.



To clean or replace strainer screen

Access to the strainer screen can be obtained by removing strainer cap. Remove strainer screen. Fit new or cleaned strainer screen into recess in cap. A new gasket should be fitted and the cap screwed into the body. The use of a thread lubricant is recommended.

To Replace Cover Studs

After removing old cover studs, fit new cover studs until the studs bottom out. The use of a thread lubricant is recommended.

Recommended Tightening Torques

Item No.	 mm or 	Nm	ft lb
7	M10 * 1.5	20-25	15-16
8	17	45-50	33-37
3	32	142-158	105-117