

Ball Float Steam Trap (Flanged)

FT 14

Description :

The FT 14 is an SG Iron Ball Float Steam Trap with integral automatic air venting facility and flanged connections.

It is available with horizontal connections with flow from right to left FT 14 (R - L), from left to right FT14(L- R). Vertical connections with flow downwards FT 14 (V) is a site modified option.

As an option a manually adjustable needle valve can be added for use as a steam lock release and is designed FT 14 - C. This is available in all three flow configurations.

Limiting Conditions (ISO 6552)

Body design conditions PN 16
 PMA - Max. allowable Pressure 16 bar g.
 TMA - Max. allowable temperature 250 0 C.
 Cold Hydraulic test pressure 24 bar g.

Operating Range :

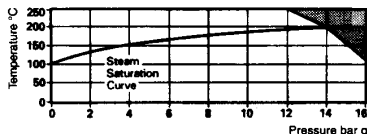

The product must not be used in this region.

Δ PMX - Max differential pressure

	Δ PMX
FT 14 - 4.5	4.5 bar
FT 14 - 10	10 bar
FT 14 - 14	14 bar

Sizes & Pipe Connections :

DN 15, 20 and 25
 Standard flange PN 16, ANSI 150, JIS / KIS 10.

Materials :

No	Part	Material	Specification
1	† Body	SG Iron	DIN 1693 GGG 40.3
2	Cover Bolts	Steel	BS 3692 Gr 8.8
3	Cover Gasket	Reinforced Exfoliated Graphite	
4	Cover	SG Iron	DIN 1693 GG40.3
5	Main Valve Assembly Screws	St. Steel	BS 970 431 S29
6	Main Valve / Air Vent Seat Gasket	St. Steel	BS 1449 304 S11
7	Main Valve Assembly Screws	St. Steel	BS 6105 Cl A2-70
8	Ball Float & Lever	St. Steel	BS 1449 304 S16
9	Air Vent Assembly	St. Steel	
10	SLR Assembly	St. Steel	BS 970 303 S21
11	SLR Gasket	St. Steel	BS 1449 304 S16
12	Pivot Frame	St. Steel	BS 1449 304 S16
13	SLR Seal	Graphite	
14	Pivot	St. Steel	
15	† Erosion Deflector 1" only	St. Steel	BS 970 431 S29
16	Valve Spring (DN 25 only)	St. Steel	BS 2056 302 S26

† Note : Item 15 is pressed into item 1 (DN 25 only)

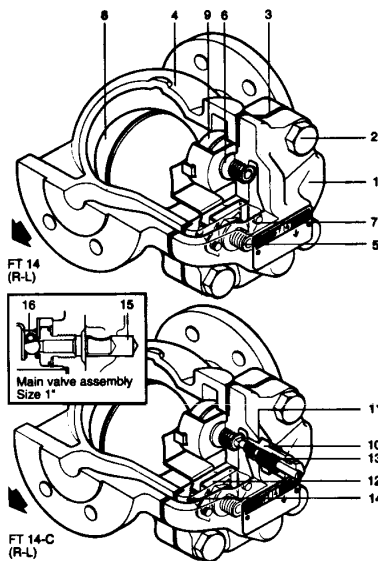

Dimensions (approx.) in mm

	A		B	C	D	E	F	G	Weight
DN	DN / ANSI	JIS / KIS							
15	150	150	107	101	51	47	26.5	115	4.5 kg.
20	150	150	107	101	55	47	26.5	115	5 kg.
25	160	170	117	70	100	10	21	120	6.5 kg.

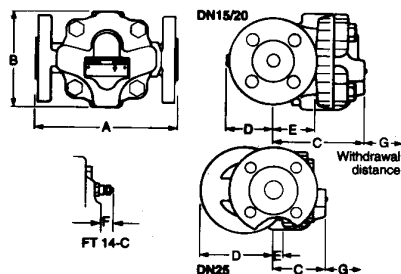

Capacities :

Note : Capacities shown are based on discharge at saturation temperature. When discharge sub - cooled condensate the air vent provides extra capacity. Under start up conditions the thermostatic air vent will be open, and will provide additional condensate capacity to the main valve assembly. On 4.5 bar units this will provide a minimum of 50 % increased capacity above the hot condensate figures shown. On 10 and 14 bar units this will be a minimum increase of 100 % on the published capacity. See TI - S02-28 for full details.

Available Certification :

This product is available with material certification to EN 10204 - 28 as standard.

How to Specify :

½" Spirax Sarco FT - 4.5 (R - L) Steam Trap with screwed BSP connections (right to left) and integral air vent. Maintainable in line. Modification of flow orientation can be changed on site.

Installation :

The Trap must be fitted with the float arm in a horizontal plane so that it rises and falls vertically. Therefore the arrow on nameplate must point downwards. Traps can be supplied with vertical connections with the flow from top inlet to bottom or horizontal connections with the flow right to left or left to right. Unless specified, a right to left flow will be supplied.(R - L)

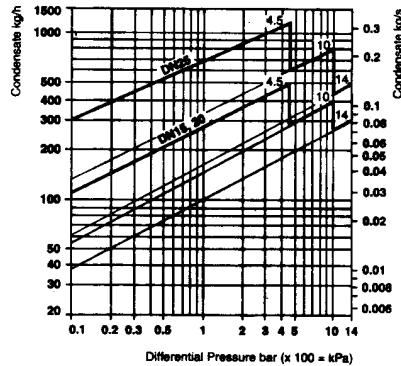

The connection orientation can be changed on sight by undoing the four cover bolts and moving the cover to the preferred flow orientation.

A new cover gasket must always be fitted.

The FT 14 - C is supplied with the steam lock release (SLR) set in the bleed position. The unit should be screwed clockwise to close.

Spare Parts :

The spare parts are shown in heavy outline. Parts drawn in broken line are not supplied as spares.

AVAILABLE SPARE	
Main Valve Assembly with Float	
	5,6,8,7 (2 off), 12, 3, 14, 16 (1" only)
Air Vent Assembly	3, 6, 9
Steam Lock Release & Air Vent Assembly	10, 11, 6, 9, 3
Cover Gasket (Pkt of 3)	3
Maintenance Kit	3,5,6,7,8,9,12,14,16 (DN 25 only)

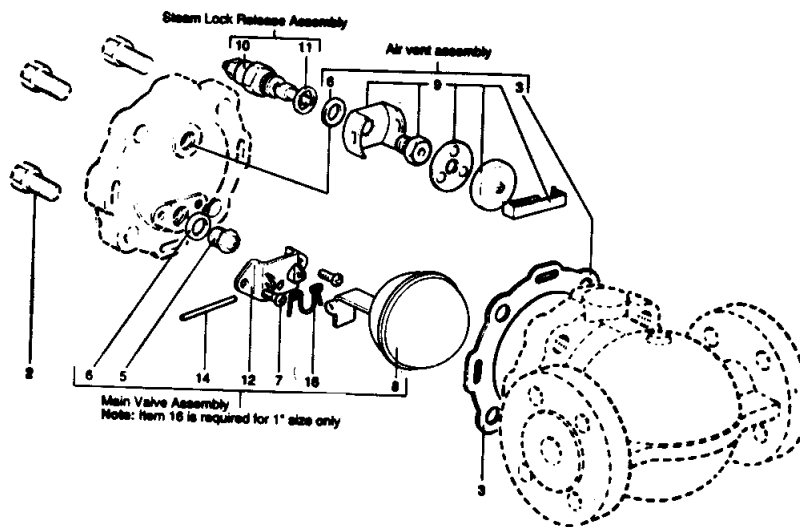

How to Order :

Always order spare by using the description given in the column headed Available Spare and stating the size and type of trap.

Example :1 - Main valve Assembly for ½" Spirax Sarco FT 14 Steam Trap. Pressure range 4.5, 10 or 14 bar.

Maintenance :

Before undertaking any maintenance on the trap it must be isolated from both the supply and return lines and any pressure allowed to safely normalise to atmosphere. The trap assembly should then be allowed to cool. When reassembling it is advisable to make sure that all joint faces are clean.



How to Fit Main Valve Assembly :

Undo cover bolts and lift off cover.
Remove complete float assembly by undoing the two screws.
Remove main valve seat and replace with a new one supplied with new gasket. A valve spring (Item 16) is fitted to 1" traps only.
Fit complete new float assembly by tightening the assembly set screws. Refit cover using new gasket.

How to Fit Air Vent Assembly :

Remove spring clip, capsule and spacer plate. Unscrew seat. Fit new gasket, new seat and frame. Assemble spacer plate, fit capsule and clip. Align complete air vent horizontally so that the frame clears the cover.

Recommended Tightening Torques :

Item	 mm or 	Nm
5	17	50 - 55
7	pozidrive M 4 X 6	2.5 - 3
9	17	50 - 55
10 + 13	19	35 - 40
2	17 M10 X 30	40 - 50